

Part Number:

**MT-TR-03-03-120-ST**

Issue Date: 06/21/2017

Series: Truss 3"

## 3" x 3" x 120" Steel ModTruss™

Part Number: *MT-TR-03-03-120-ST*



<b>Standard Material:</b>	ASTM A500 Grade B Steel
<b>Standard Finish:</b>	22 - Gloss Black
<b>Available Finish(es):</b>	24-25
<b>Size:</b>	3" x 3" x 120" (76.2mm x 76.2mm x 3048mm)
<b>Weight of Truss:</b>	49.00lbs (22.23kg)
<b>Hole Size:</b>	11/16" (17.46mm)
<b>Recommended Hardware:</b>	Black-Oxide Alloy Steel Hex Drive Flat Head Screw, 1/2"-13 Thread Size, 1" Long (M13 x 2, 24mm Long)
<b>Recommended Tools:</b>	ModTruss™ Tool Kit 1 and 5/16" Allen Wrench
<b>Associated Products:</b>	MT-AC-TR-CAP-F-0300, MT-PL-S-03-12-IS, MT-PL-S-FLT-0900-1500-0032-090-12-012
<b>See more at:</b>	<a href="http://ModTruss.com">ModTruss.com</a>

ModTruss<sup>INC</sup>



Electrical Hazard



Flammability



In Stock



Made To Order



Customizable



Reusable



Compatible



Serialized & Traceable

U.S. Patent No. 8,418,425 & other patents pending

Part Number:

**MT-TR-03-03-120-ST**

Issue Date: 06/21/2017

Series: Truss 3"

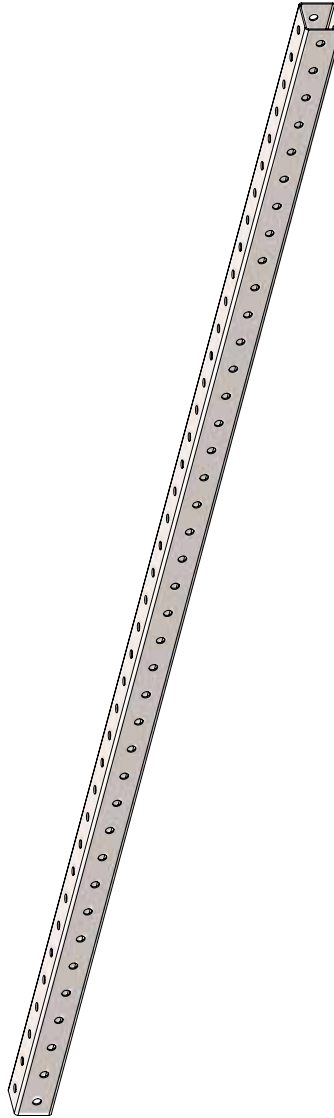
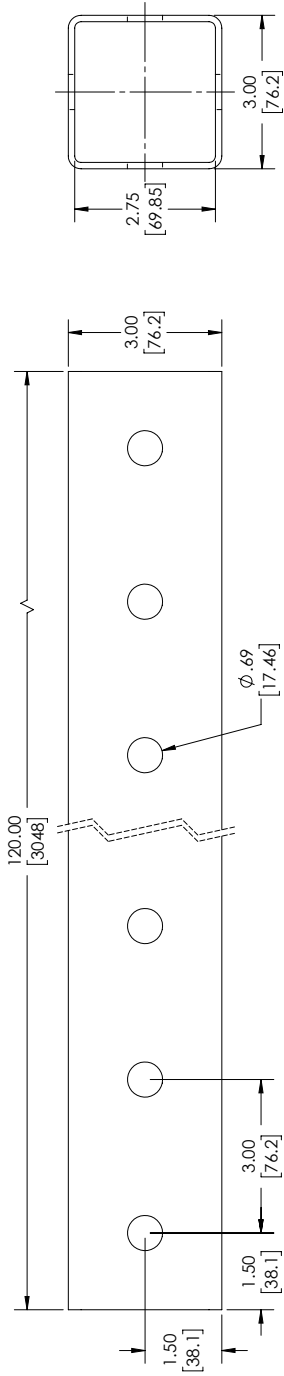

	PRECISION LEVEL: MED-1.03 (1.80) BRACKET (1) DIMENSIONS ARE IN MM
	RELEASED: 6/15/2015   REVISION: NR
DESCRIPTION:	TRUSS, 3" x 3" x 120"
PART NUMBER:	MT-TR-03-03-120-ST