

Part Number:

MT-TR-06-06-060-ST

Issue Date: 06/21/2017

Series: Truss 6"

6" x 6" x 60" Steel ModTruss™

Part Number: *MT-TR-06-06-060-ST*

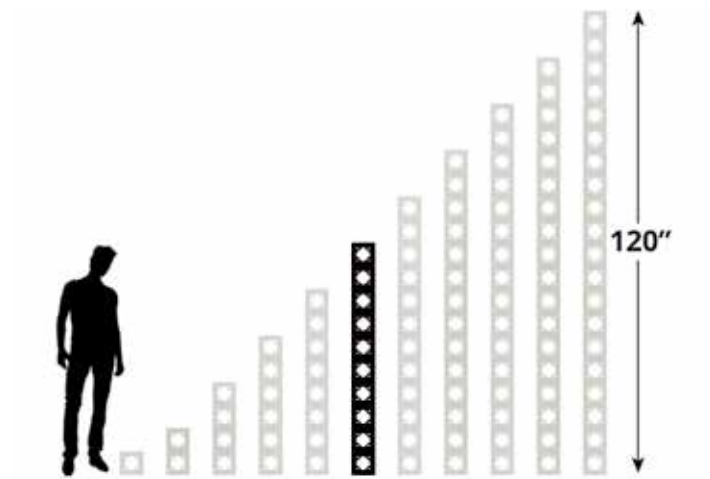

Standard Material:	A36 Low Carbon Steel
Standard Finish:	25 - Silver
Available Finish(es):	20-32
Size:	6" x 6" x 60" (152.40mm x 152.40mm x 1524mm)
Weight of Truss:	49.25lbs (22.34kg)
Hole Size:	11/16" (17.46mm)
Recommended Hardware:	5/8"-11 Thread Grade 8 Bolt, 2" Long 5/8" SAE Zinc-Plated Washer 5/8"-11 Thread, Grade 8 Hex Nut (M18 x 2 Thread, 50mm Long, Class 10.9 Bolt M18, Class 10.9 Washer M18 x 2 Thread, Class 10.9 Nut)
Recommended Tools:	ModTruss™ Tool Kit 1
Associated Products:	MT-PL-W-06, MT-PL-S-06-12
See more at:	ModTruss.com

ModTruss^{INC}



Electrical Hazard



Flammability



In Stock



Made To Order



Customizable



Reusable



Compatible



Serialized & Traceable

U.S. Patent No. 8,418,425 & other patents pending

Part Number:

MT-TR-06-06-060-ST

Issue Date: 06/21/2017

Series: Truss 6"

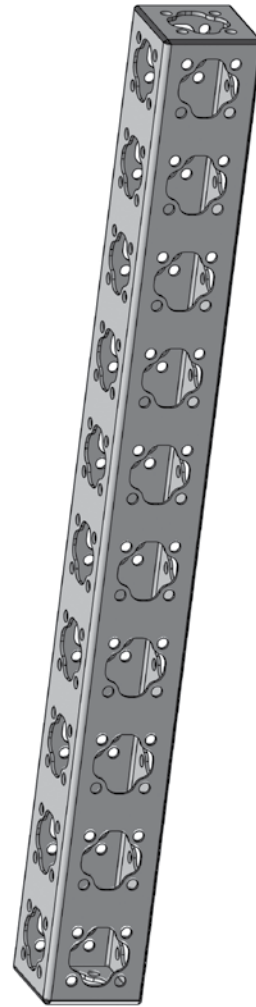
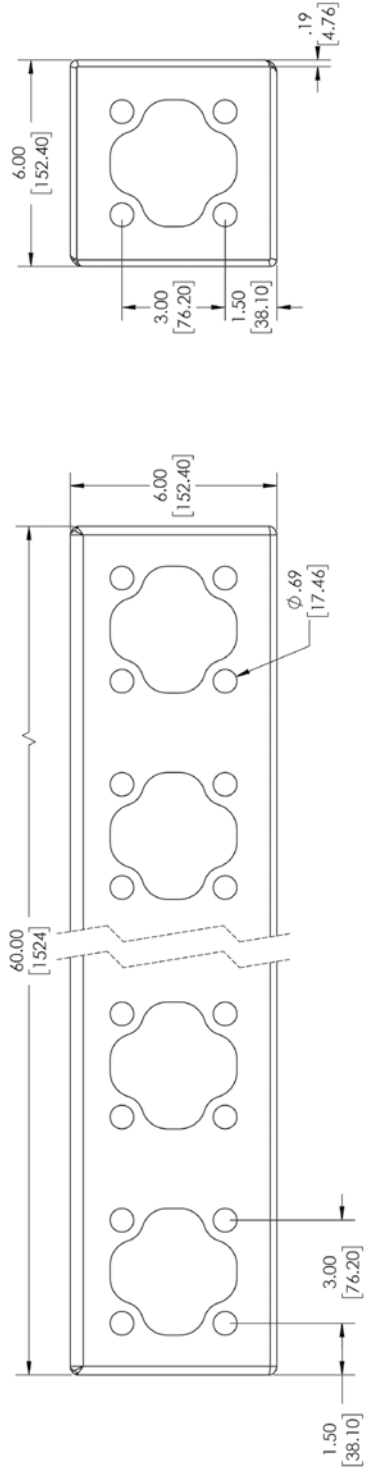

	PRECISION LEVEL, MED. - 106 [1.29] BRACKET [1] DIMENSIONS ARE IN MM
	RELEASED: 5/12/2015 REVISION: NR
DESCRIPTION:	TRUSS, 6"x6"x60"
PART NUMBER:	MT-TR-06-06-060-ST