

3" Frame Extrusion

Part Number | MT-EX-03-FR-XXX-AL

XXX = Length in inches (EX length is cut to order)

PRO TIP

The **3" Frame Extrusion** is the perfect solutions for walls, partitions, scenic flats and more.



Standard Material	6061-T6 Aluminum
Standard Finish	02 - Mill
Available Finish(es)	10-12, 20-33
Size	3.0" x 1.88" x User Defined Length (76.20mm x 47.63mm x User Defined Length)
Weight	1.5lbs (0.68kg) <i>per foot</i>
Hole Size	11/16" (17.46mm)
Recommended Hardware	1/4" x 1" Steel Pop Rivets
Recommended Tools	Tool Kit 1 Miter Saw Pneumatic Pop Rivet Gun
For More Info	www.ModTruss.com

- 
Electrical Hazard
- 
Flammability
- 
In Stock
- 
Made To Order
- 
Customizable
- 
Reusable
- 
Compatible
- 
Serialized & Traceable

U.S. Patent No. 8,418,425 & other patents pending

TR

EX

PL

JH

PA

HG

MR

AC

HW

TK

MH

FH

GL

Series | EX Extrusion

Product Number | MT-EX-03-FR-XXX-AL

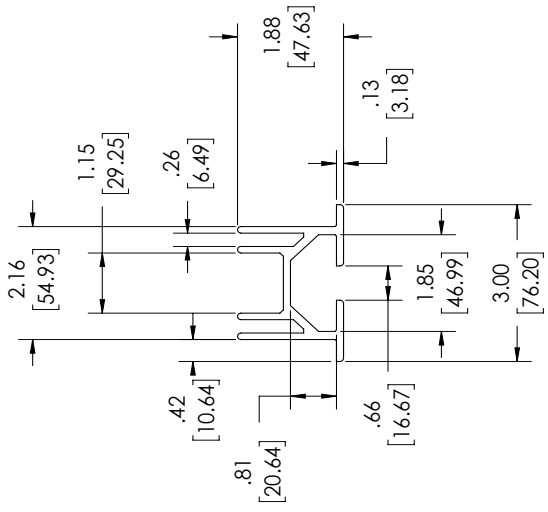
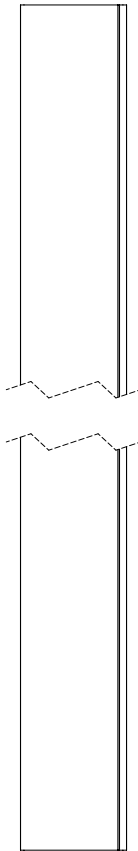
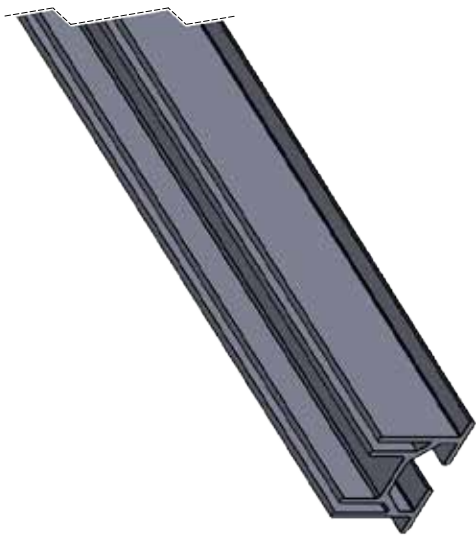

LENGHT	PART NUMBER
12"	MT-EX-03-FR-012-AL
24"	MT-EX-03-FR-024-AL
36"	MT-EX-03-FR-036-AL
48"	MT-EX-03-FR-048-AL
60"	MT-EX-03-FR-060-AL
72"	MT-EX-03-FR-072-AL
84"	MT-EX-03-FR-084-AL
96"	MT-EX-03-FR-096-AL
108"	MT-EX-03-FR-108-AL
120"	MT-EX-03-FR-120-AL

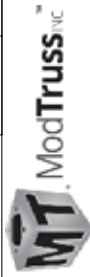

6/10/2019	REVISION: VI
DESCRIPTION: 3" FRAME EXTRUSION	
PART NUMBER: MT-EX-03-FR-XXX-AL	